

Division: Alabama Division

Control Station: 139N

Class Code: H50

Industry Name: Western Threaders





Version: January 12, 2018

Physical Characteristics

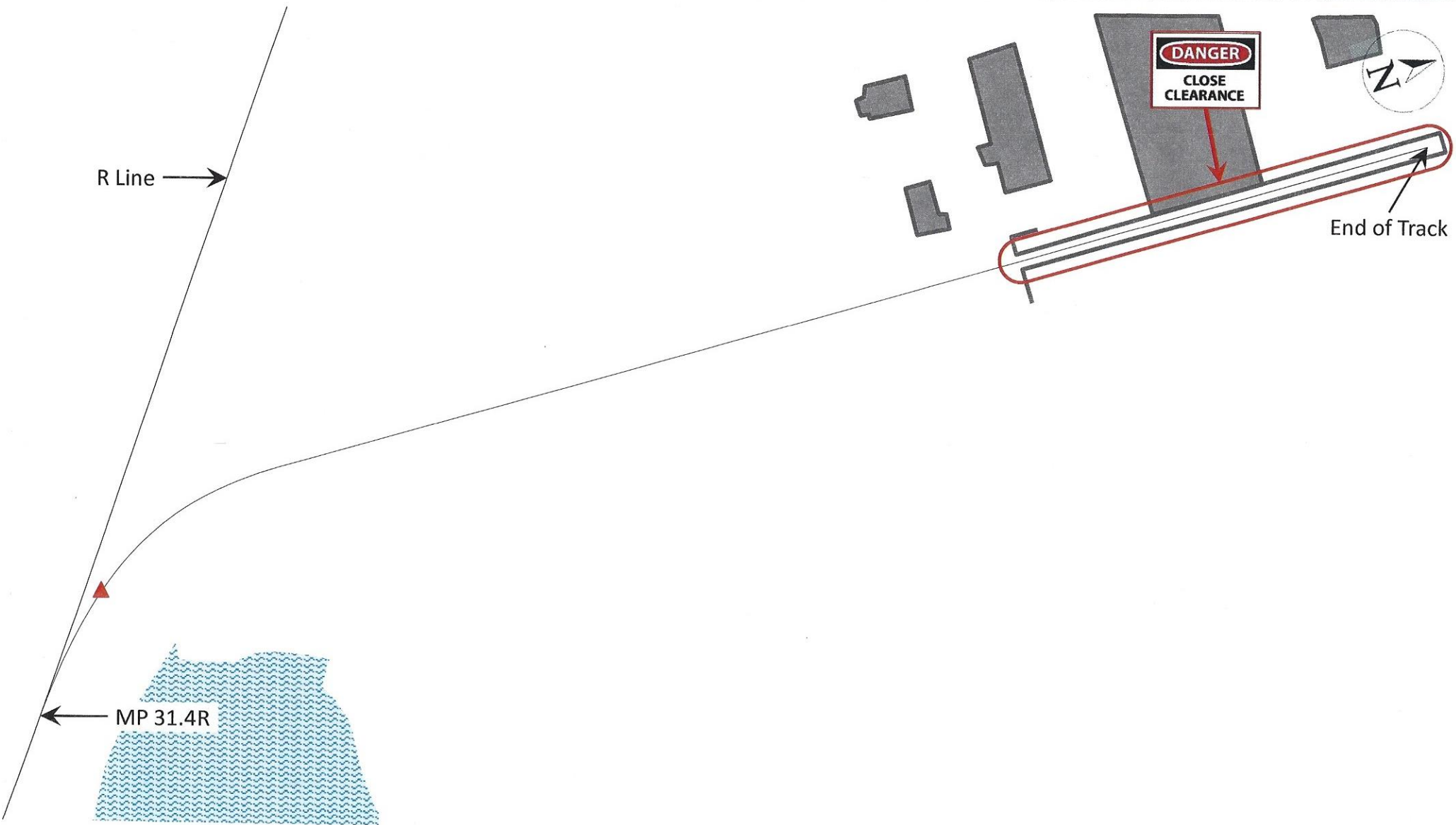
The graphics on the following pages provide an overhead view and a one-line diagram of the track layout and contain the following physical characteristics:

- MP 31.4R
- Derail
- Close Clearance
- R Line
- End of Track



 = Derail	 = Industry Gate	 = Close Clearance	 = Lead Line	 = Industry Track
For Reference Only				